

Schedule 1 – Description of ILUA Area

The ILUA Area comprises:

(a) NT Portion 7581

(b) NT Portion 7582,

being an area of approximately 9390m² as shown on the plans at Schedule 2.

Schedule 2 – Plans of ILUA Area

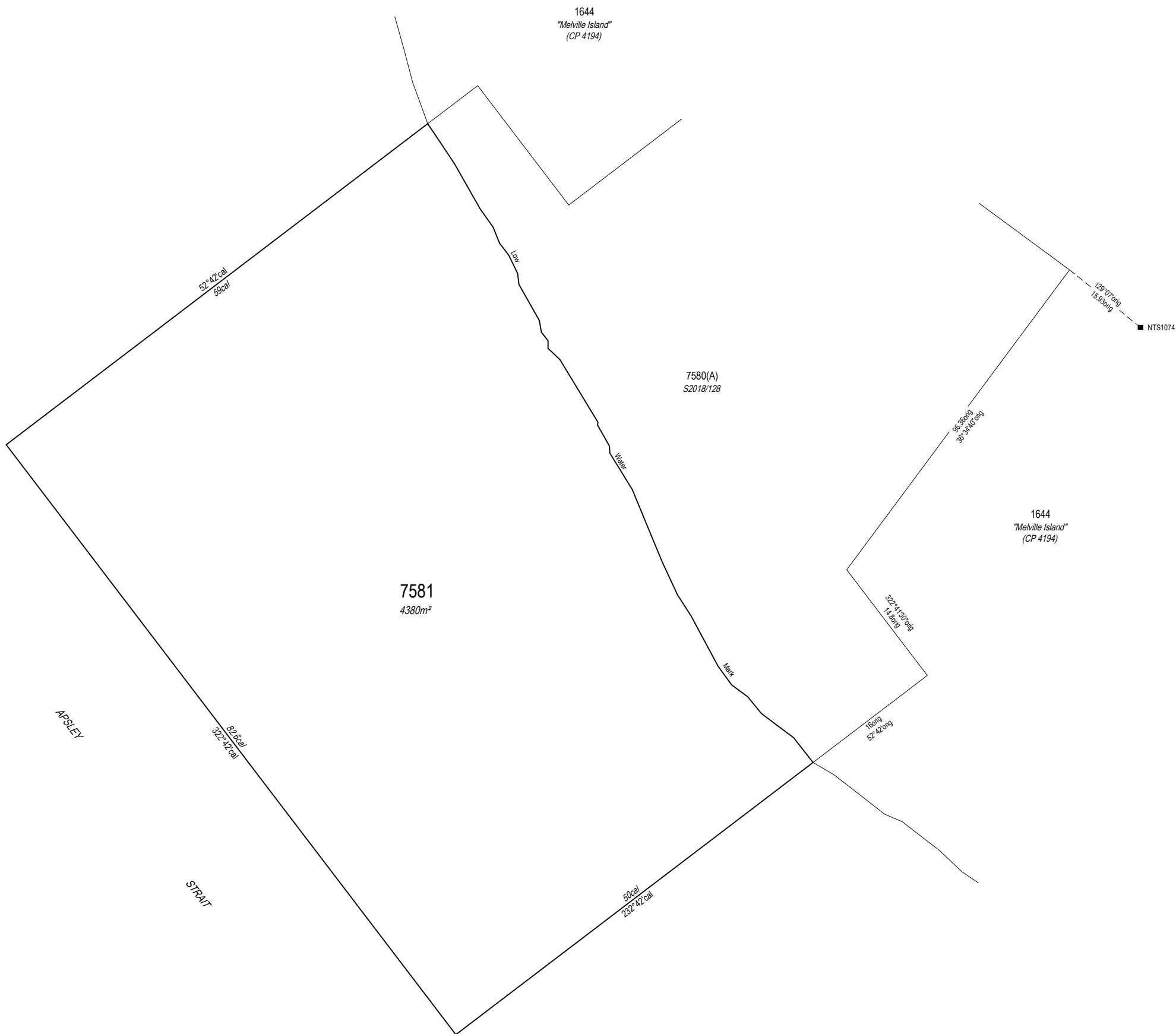
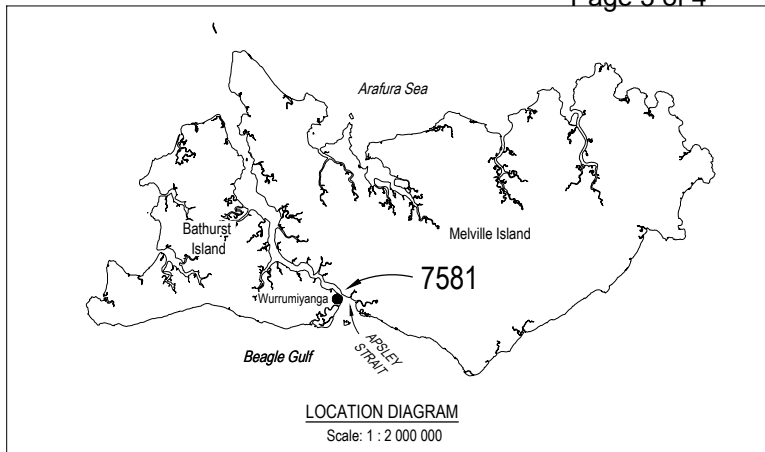

Keith Leslie Schulz hereby certify that the survey represented on this plan was carried out by me or under my supervision and was completed on . . . 11/5/2020 and that this survey has been executed in accordance with the Licensed Surveyors Act and the Directions thereunder.

K Schulz 11/5/2020
 Licensed Surveyor Date

SURVEY APPROVED
Robert Loh 14 May 2020
 Surveyor-General Date

Version 1.2 - survey plan as lodged

Field Book
 EJA REF: 10606

Drawn
 Earl James & Associates
 11/5/2020

Examined
 Earl James & Associates
 11/5/2020

Map Reference

 True Mid Bearings

AZIMUTH
 Assumed from . . . S2018/128
 Observed at

LEGEND

Concrete Post

Concrete Block

Peg or Wooden Post

Reference Mark

Locksplit

Fence Post

NT PORTION 7581
TIWI ISLANDS LOCALITY

SCALE 1:500 (A3)

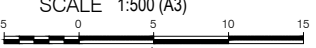

S2020/017

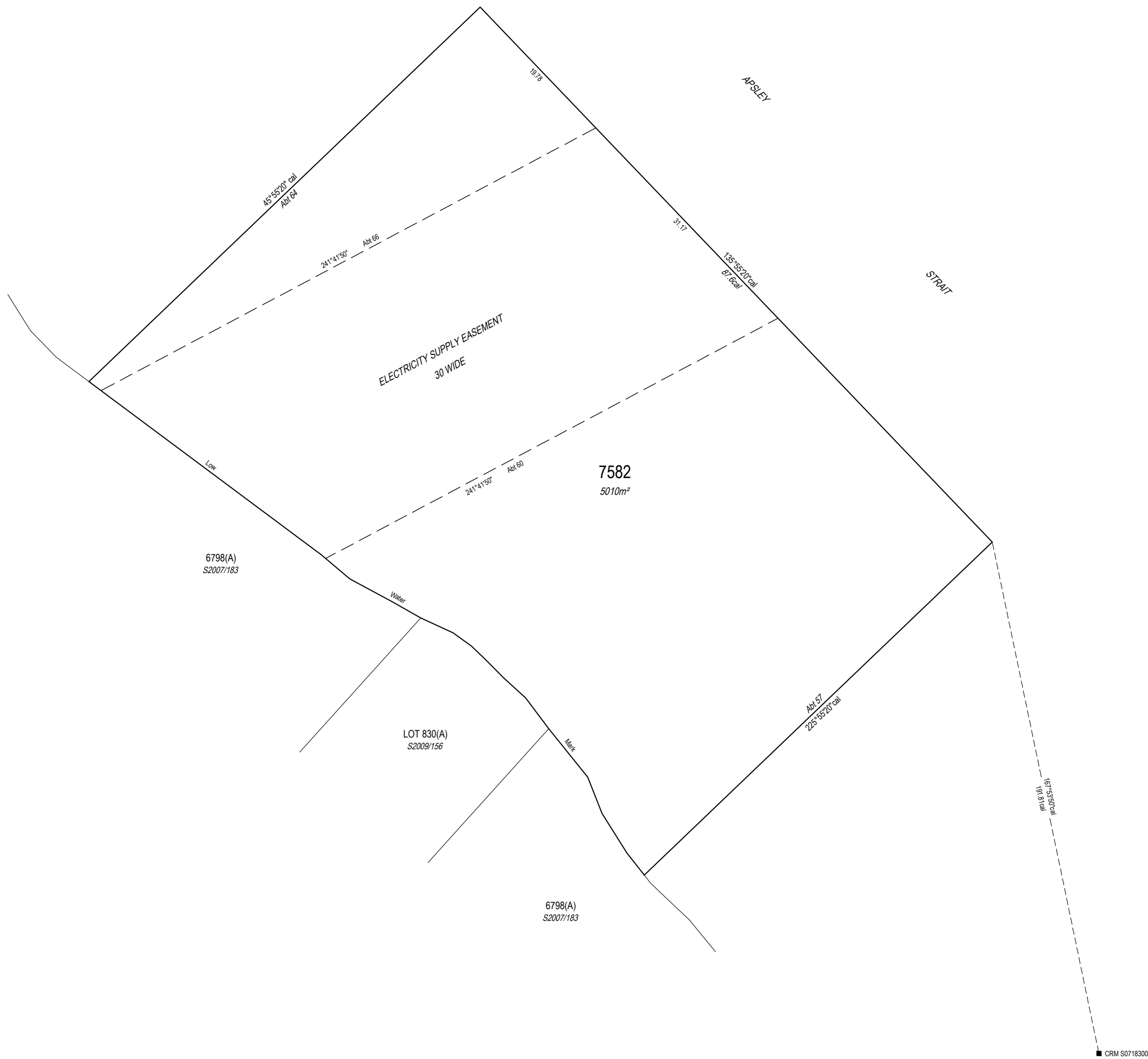
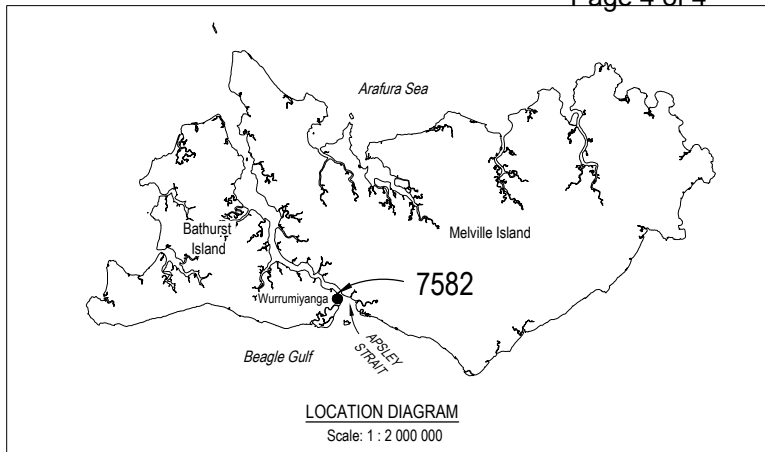

Keith Leslie Schulz hereby certify that the survey represented on this plan was carried out by me or under my supervision and was completed on . . . 11/5/2020 and that this survey has been executed in accordance with the Licensed Surveyors Act and the Directions thereunder.

K Schulz 11/5/2020
 Licensed Surveyor Date

SURVEY APPROVED
Ruth Loh 14 May 2020
 Surveyor-General Date

Note
 Electricity Supply Easement is in favour of the Power and Water Corporation and is to be created by registration of this plan

Version 1.1 - survey plan as lodged

Field Book
 EJA REF:10606

Drawn
 Earl James & Associates
 11/5/2020

Examined
 Earl James & Associates
 11/5/2020

Map Reference

 True Bearings

AZIMUTH
 Assumed from S2009/156
 Observed at

LEGEND

Concrete Post

Concrete Block

Peg or Wooden Post

Reference Mark

Lockspit

Fence Post

NT PORTION 7582
TIWI ISLANDS LOCALITY

SCALE 1:500 (A3)

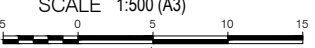

S2020/018